

KENTURN

since 1983



Built-in Motor

SPINDLES



CNC Machining Center Spindles

MVB0925

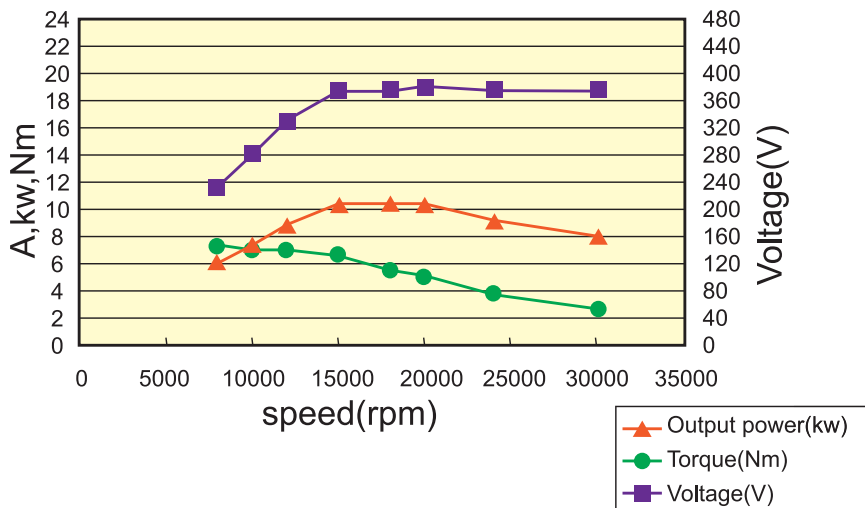

Shank	BBT30
Body Outer Dia	Ø120
Max. Speed	24000rpm
Lubrication	Grease
Output Power	10.3kw
Voltage	380V
Torque	8.2Nm

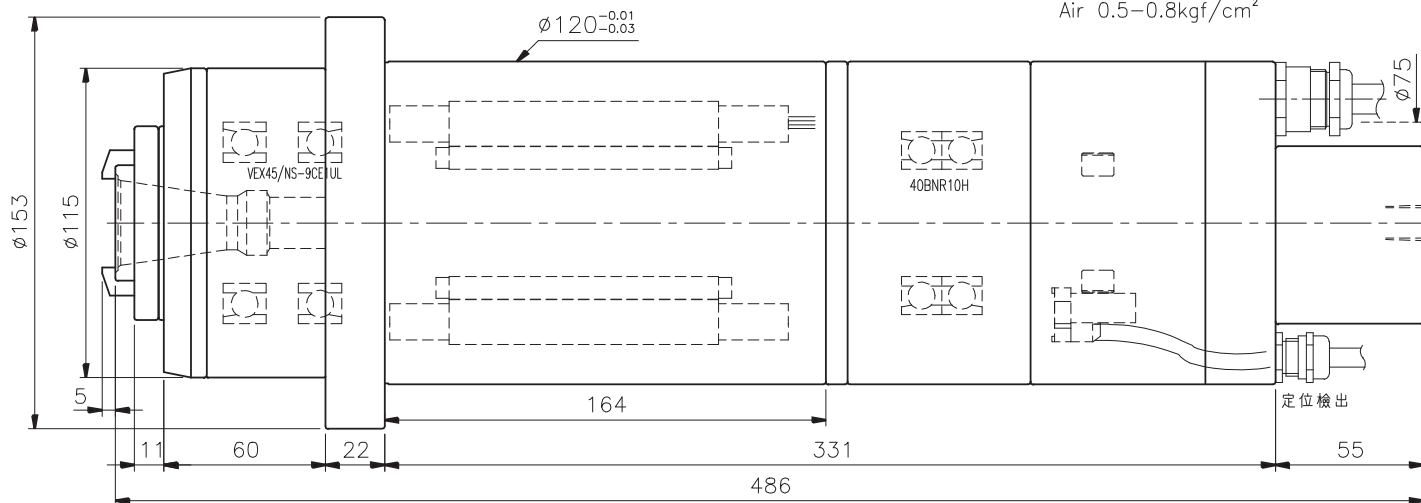
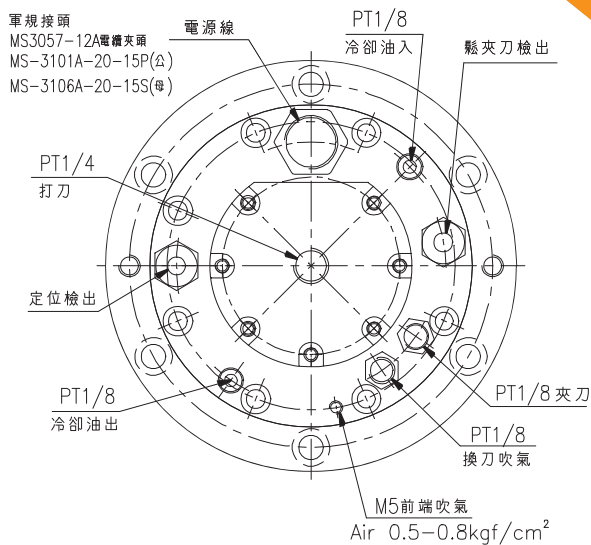
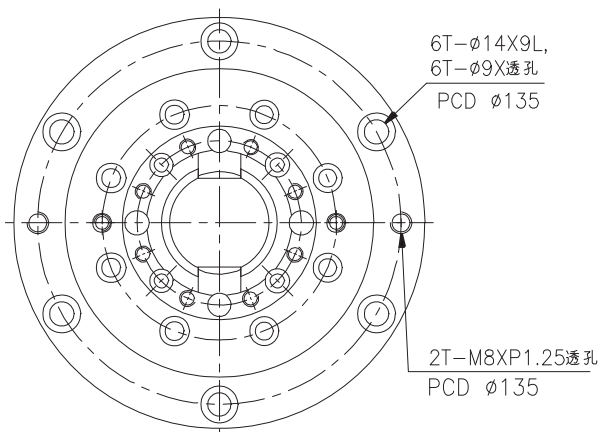

MVB0925C

CNC Machining Center Spindles

Shank BBT30
 Body Outer Dia $\varnothing 120$
 Max. Speed 24000rpm
 Lubrication Grease
 Output Power 6.3kw
 Voltage 380V
 Torque 5Nm

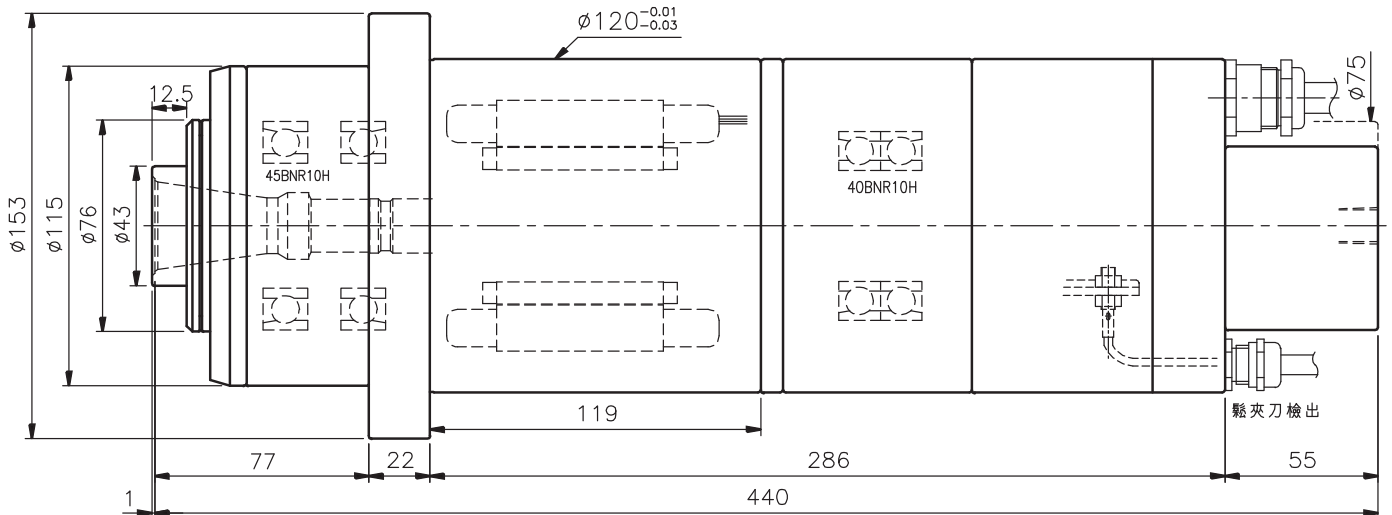
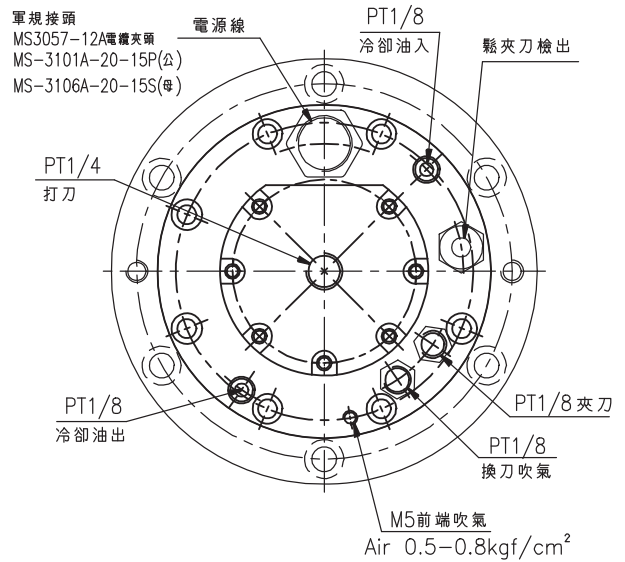
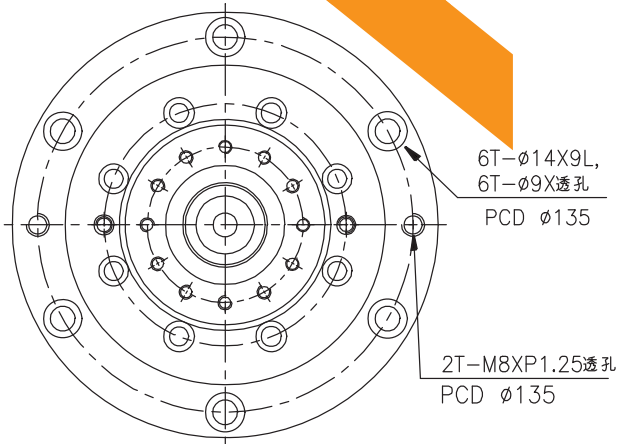
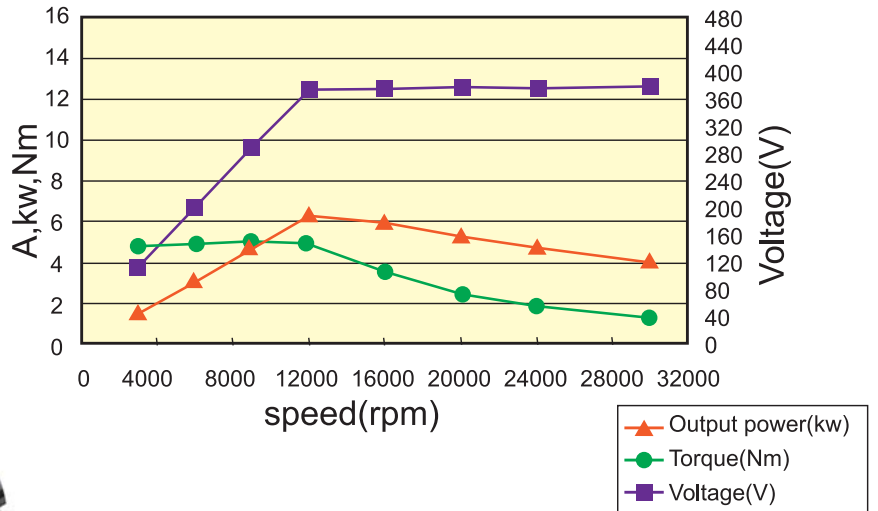

CNC Machining Center Spindles

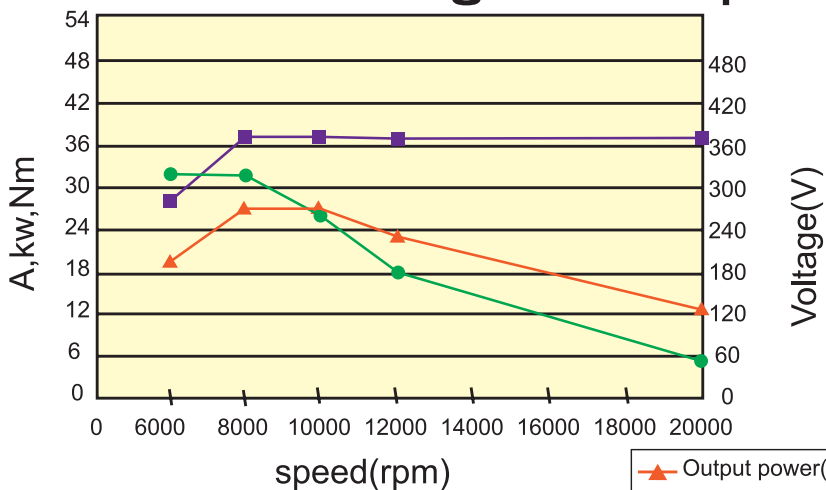

MVB1318

Shank	HSK-A63
Body Outer Dia	Ø190
Max. Speed	20000rpm
Lubrication	Oil-Air
Output Power	27.3kw
Voltage	380V
Torque	32.6Nm

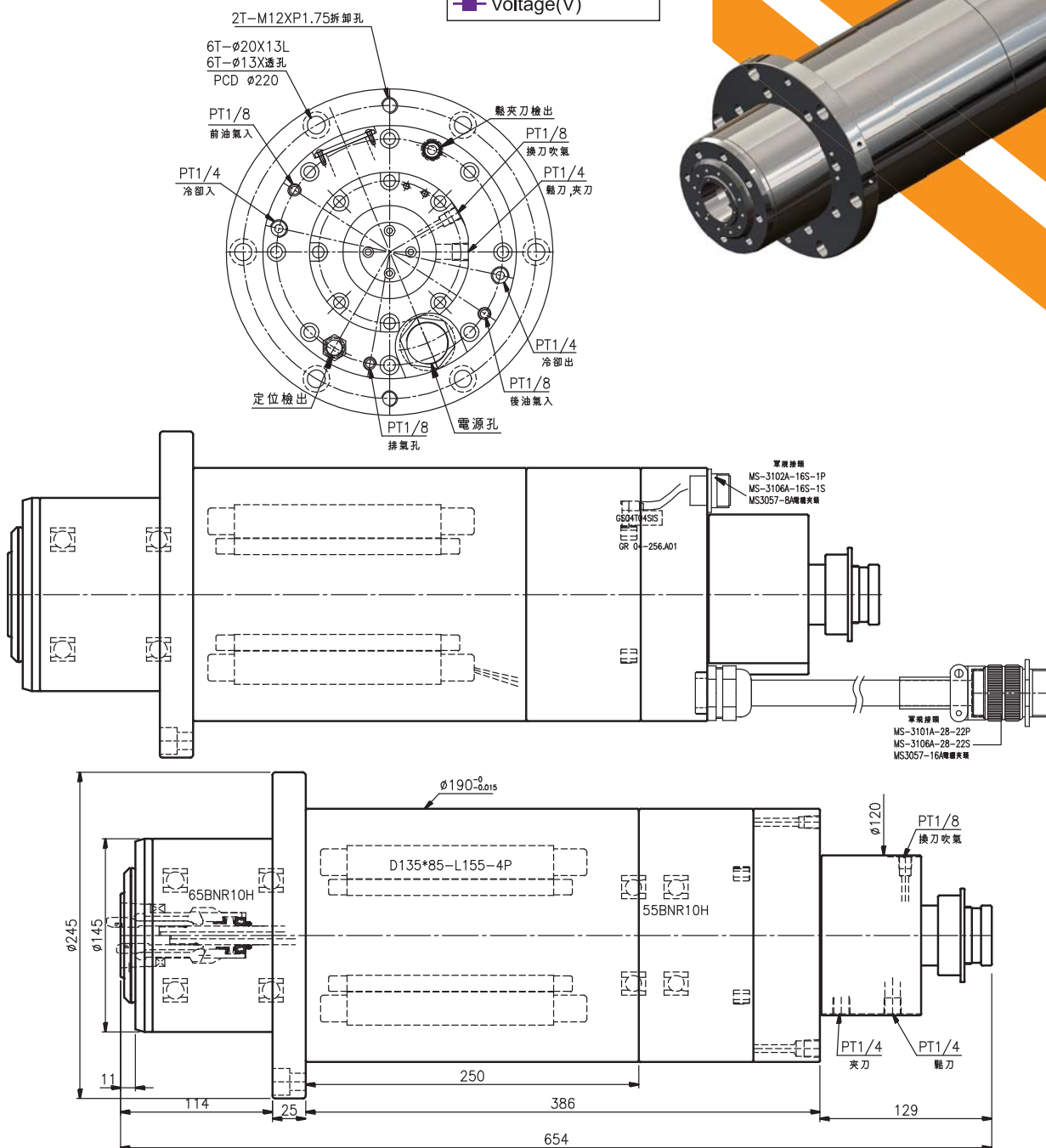

MVB1412

CNC Machining Center Spindles

Shank BT40/HSK-A63
 Body Outer Dia $\varnothing 220$
 Max. Speed 12000rpm
 Lubrication Grease
 Output Power 30.1kw
 Voltage 380V
 Torque 96Nm

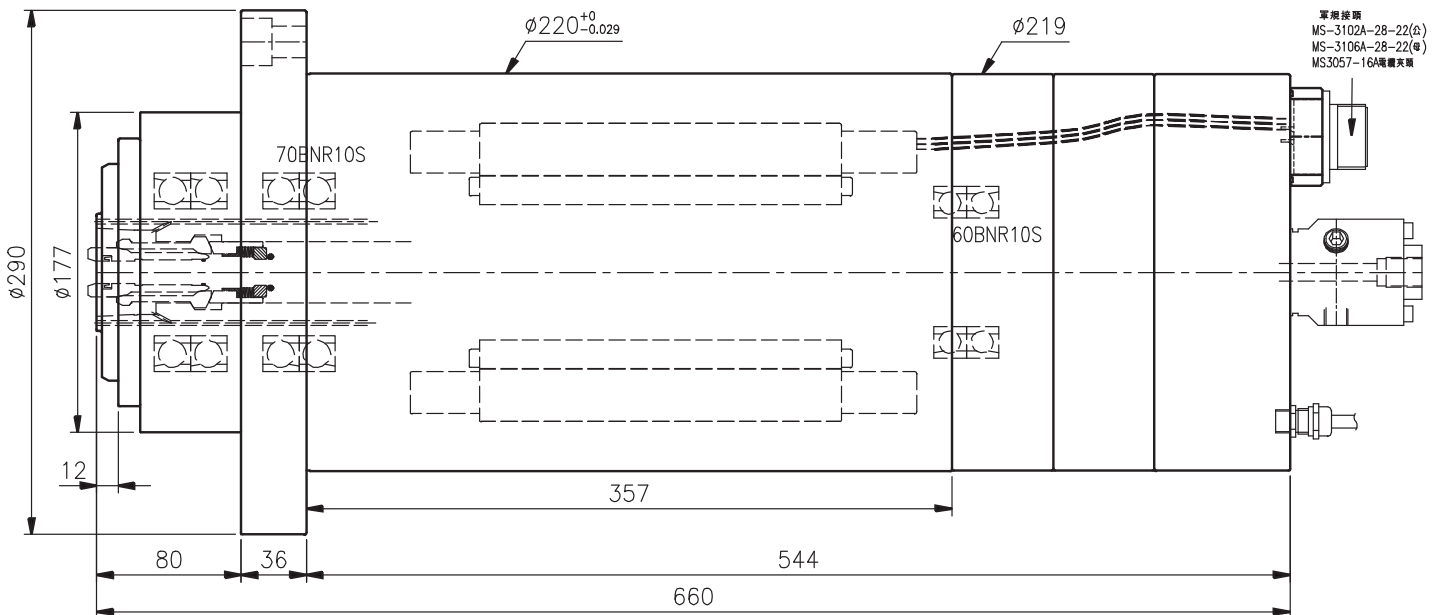
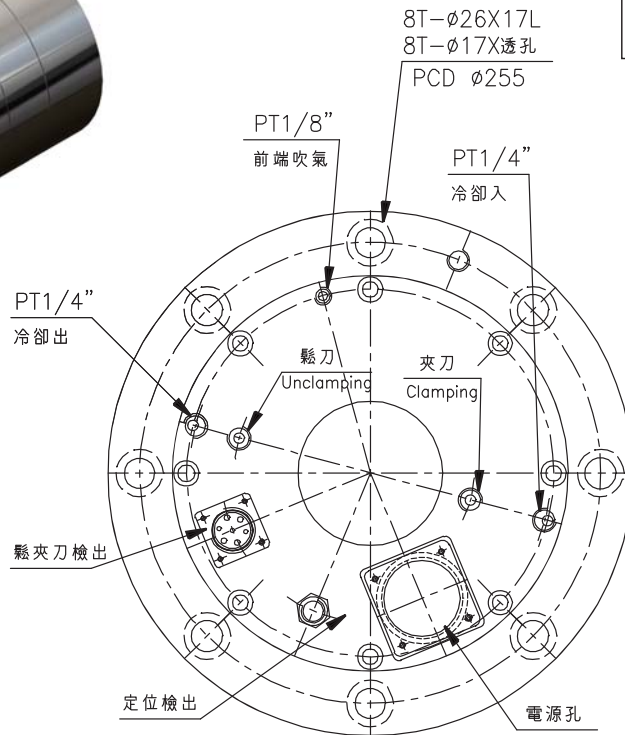
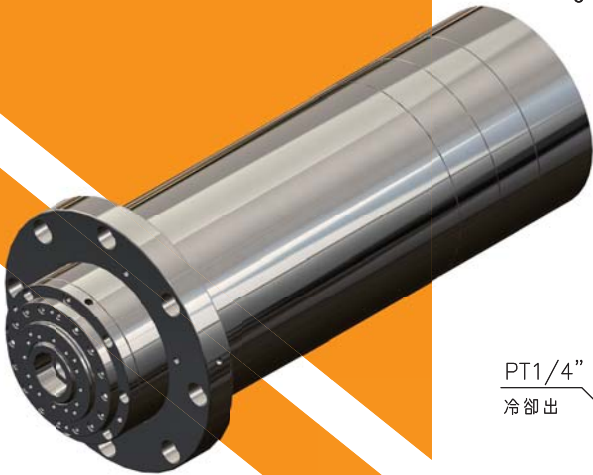
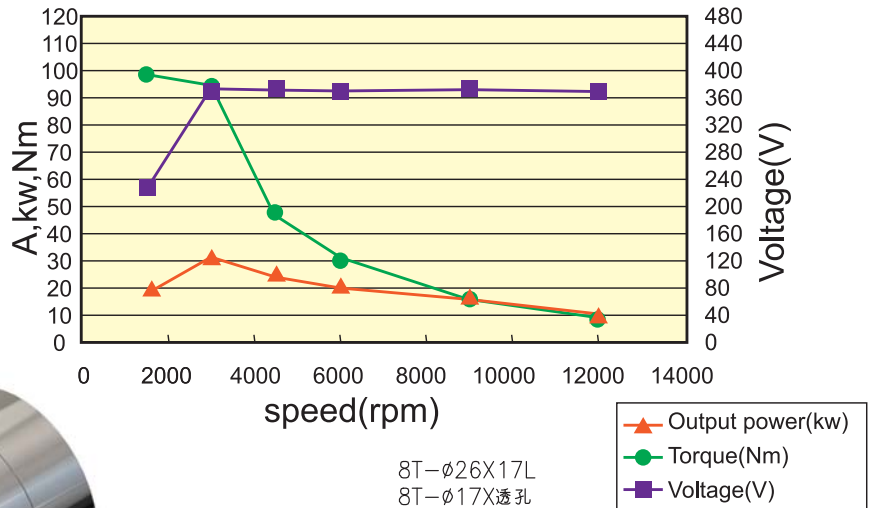

CNC Machining Center Spindles

MHB2010B

Model: B112S/15000(A06B-1671-B120#ZAB1)

Shank	BT50
Body Outer Dia	Ø240
Max. Speed	10000rpm
Lubrication	Oil-Air
Output Power	5.5kw
Voltage	220V
Torque	5.3Nm

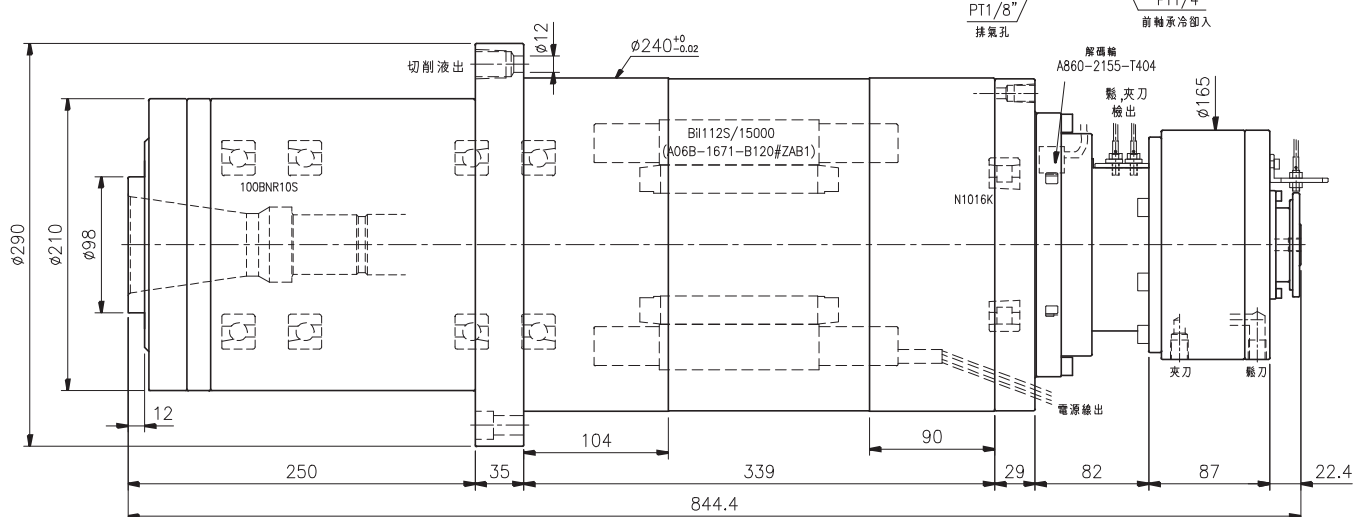
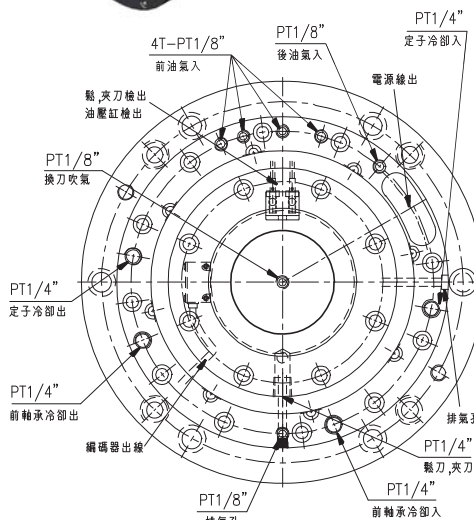
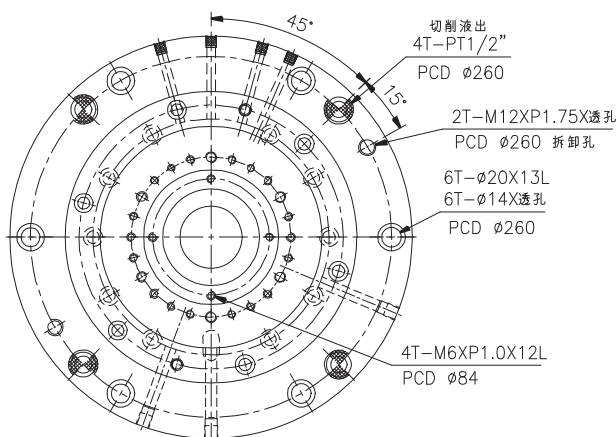
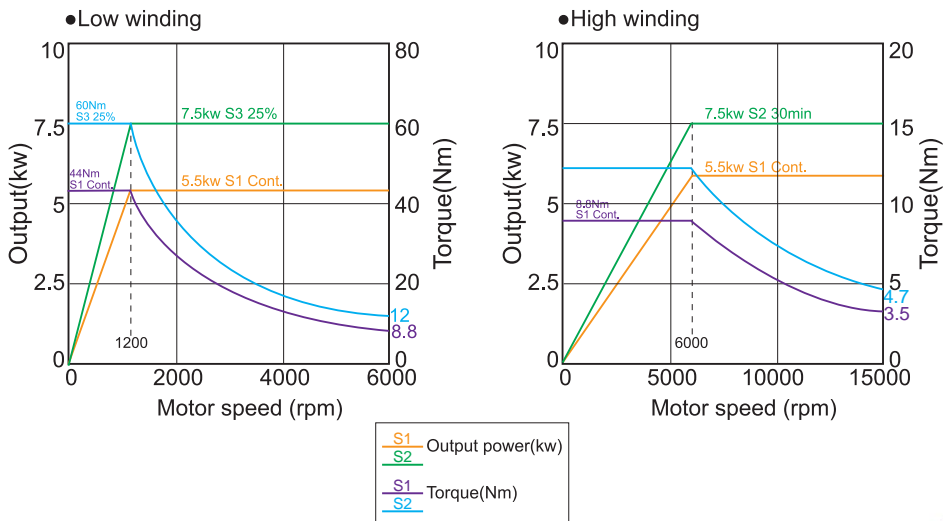

GVB0520

Collet	ER16
Body Outer Dia	Ø90
Max. Speed	24000rpm
Lubrication	Grease
Output Power	2kw
Voltage	200V
Torque	0.8Nm

CNC Engraving And Milling Machine Center Spindles

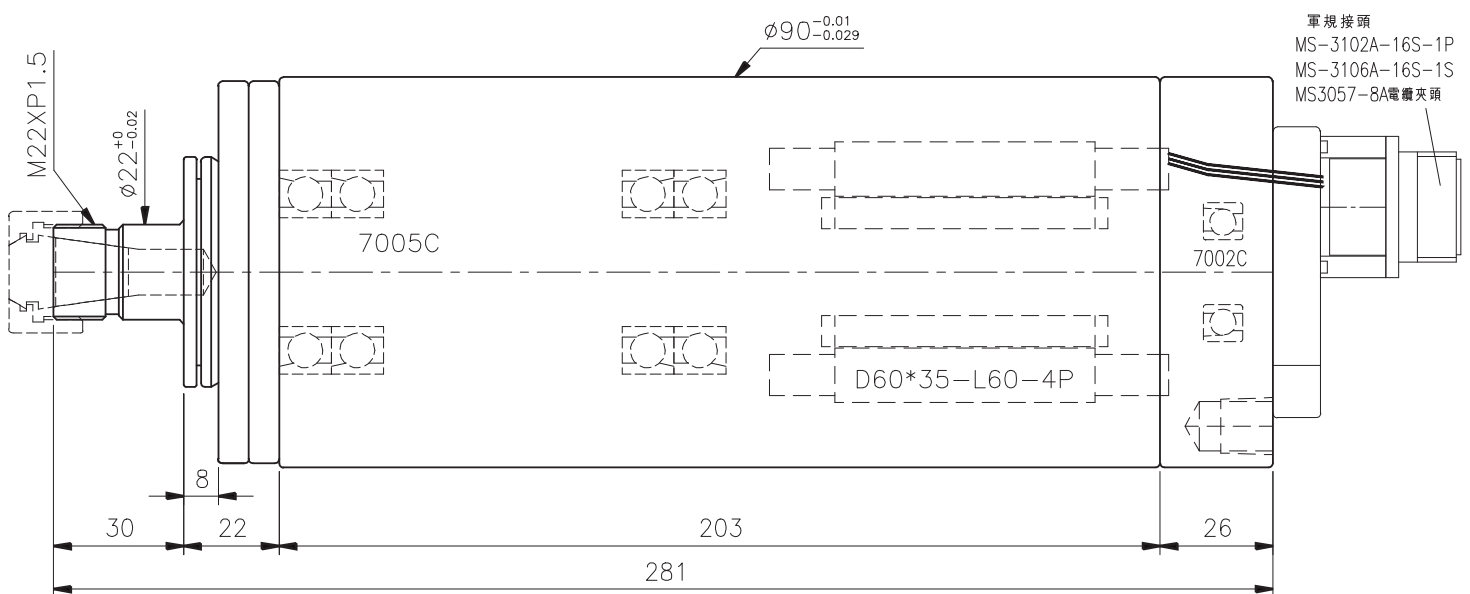
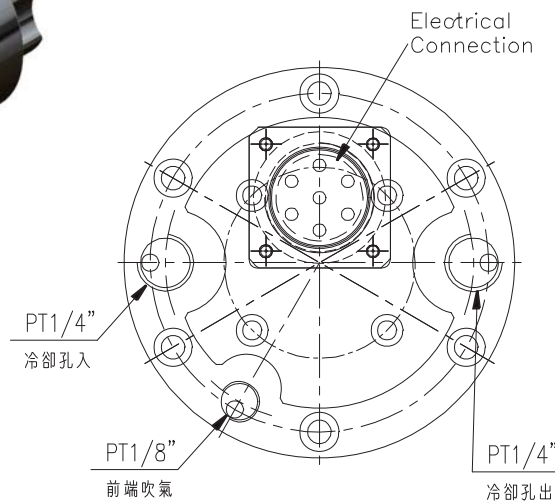
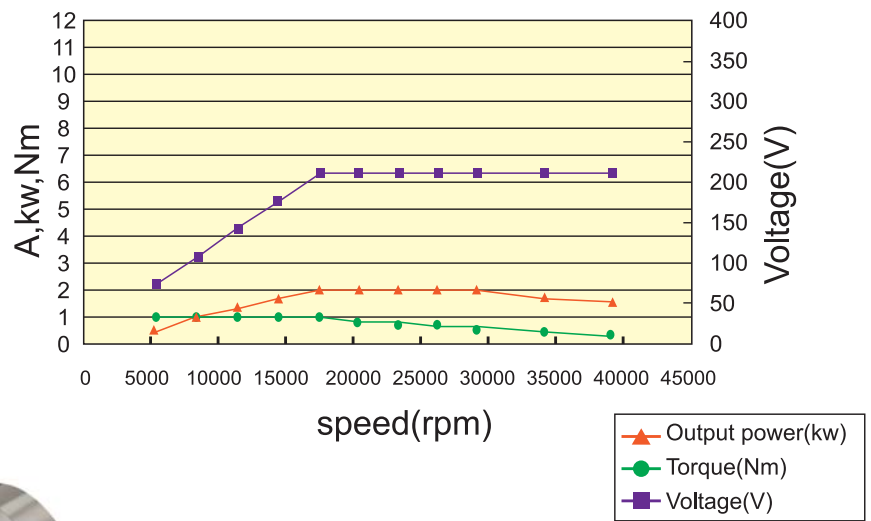

CNC Engraving And Milling Machine Center Spindles

MEB0820

Collet	ER20
Body Outer Dia	Ø120
Max. Speed	22000rpm
Lubrication	Grease
Output Power	2.2kw
Voltage	346.5V
Torque	0.4Nm

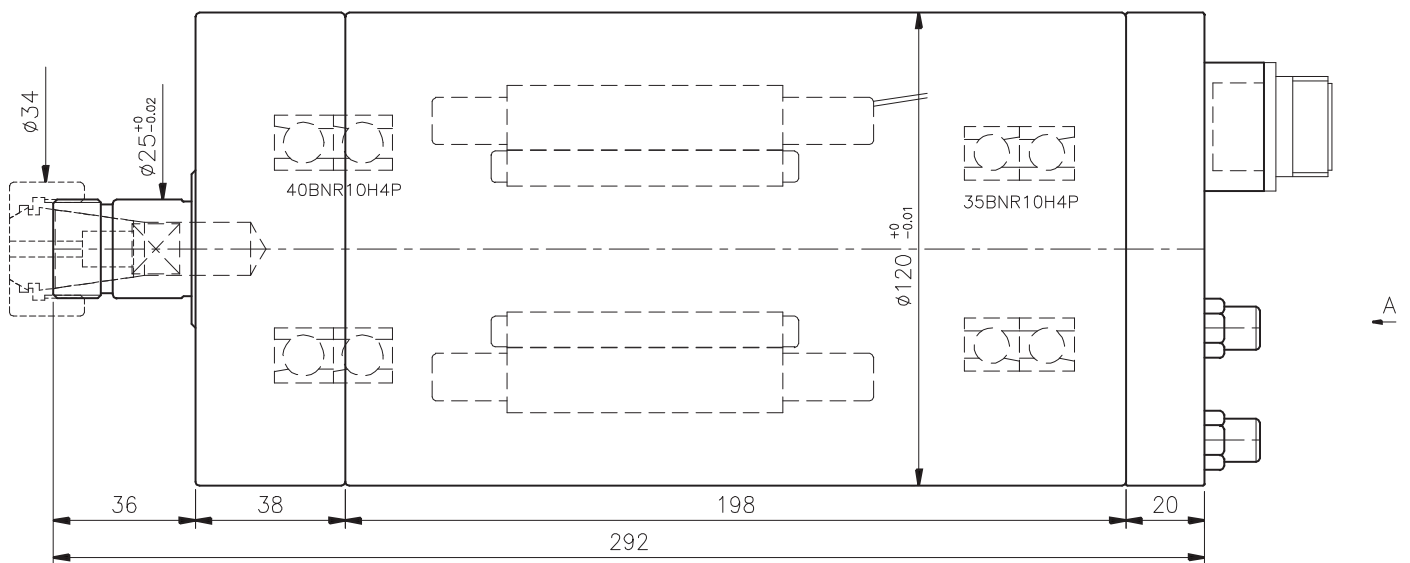
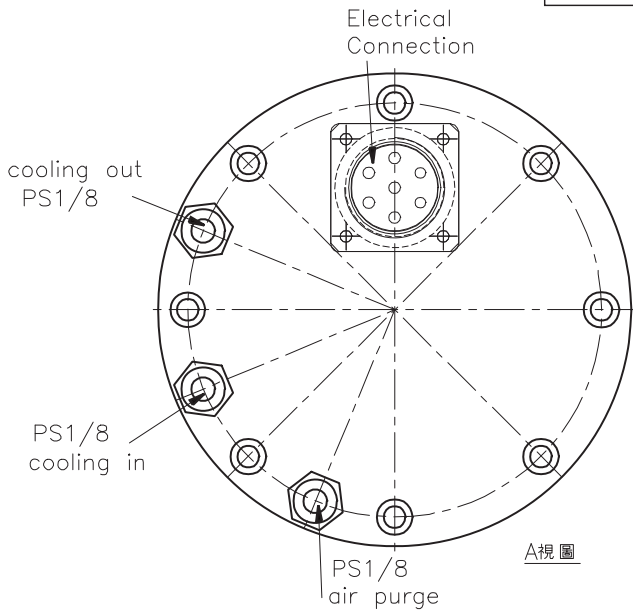
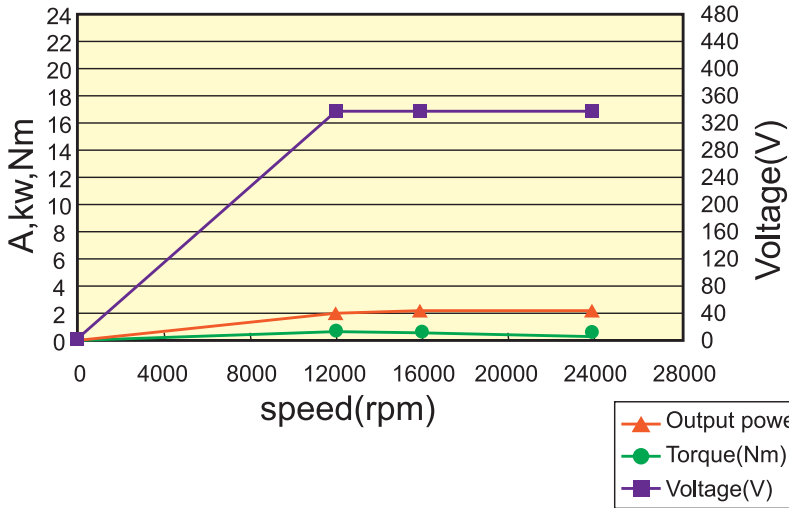

PC0260A

Collet	-
Body Outer Dia	Ø61.91
Max. Speed	60000rpm
Lubrication	Grease
Output Power	4.2kw
Voltage	220V
Torque	0.7Nm

CNC Engraving And Milling Machine Center Spindles

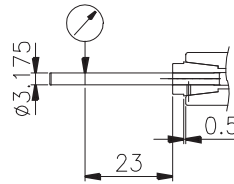
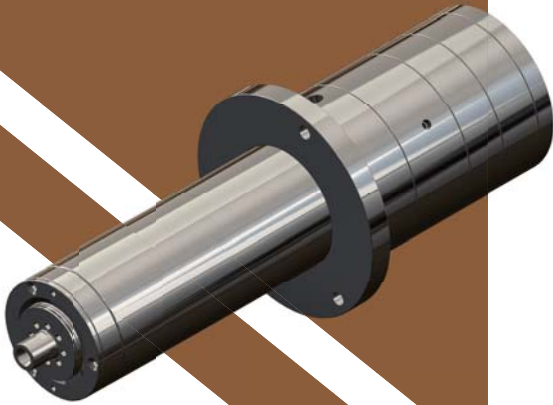
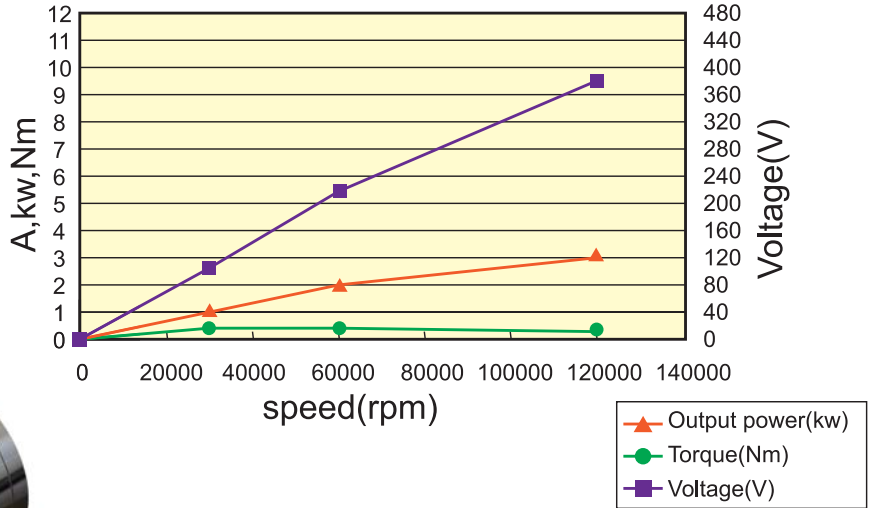

筒夾安裝：
夾一Ø3.175圓棒
筒夾端面浮出鼻端約0.5mm

檢驗：
夾一Ø3.175圓棒
距離鼻端23mm處
偏擺0.01mm內

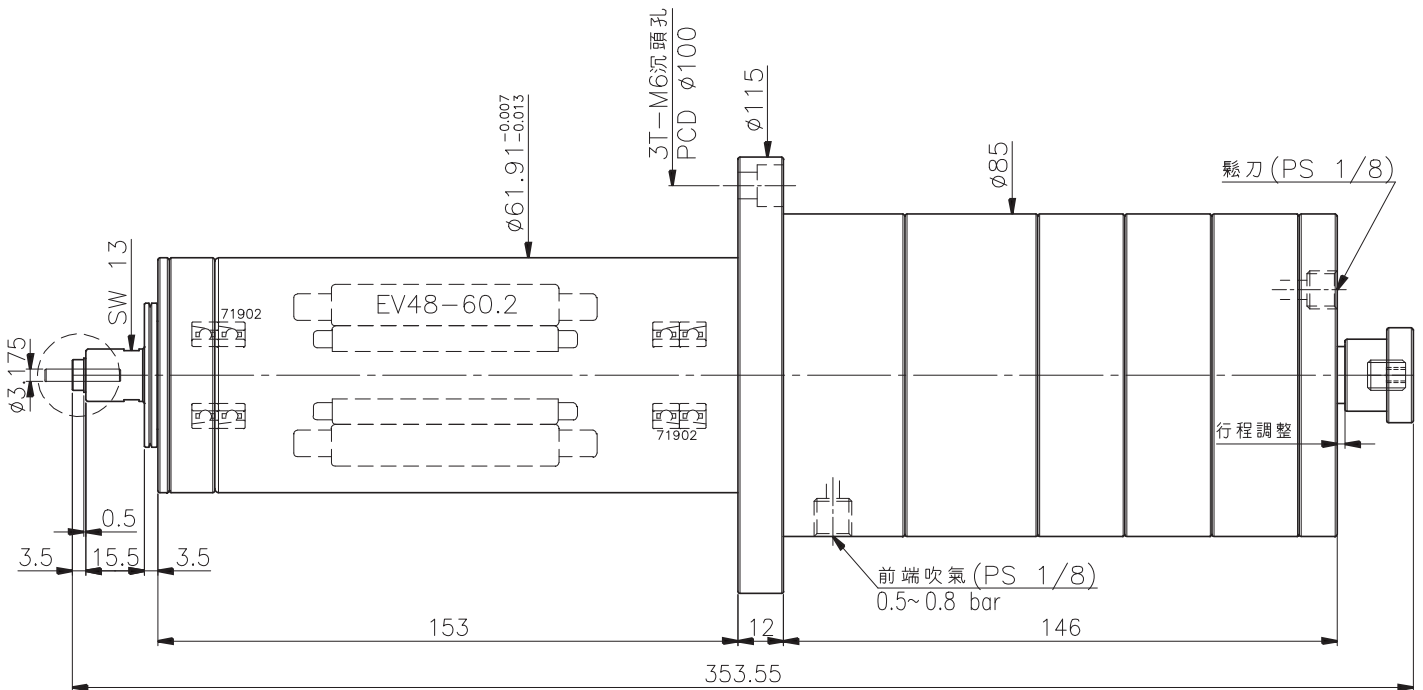

CNC Grinding Machine Spindles

FG0510

Collet	-
Body Outer Dia	Ø80
Max. Speed	10000rpm
Lubrication	Grease
Output Power	1.4kw
Voltage	380V
Torque	1Nm

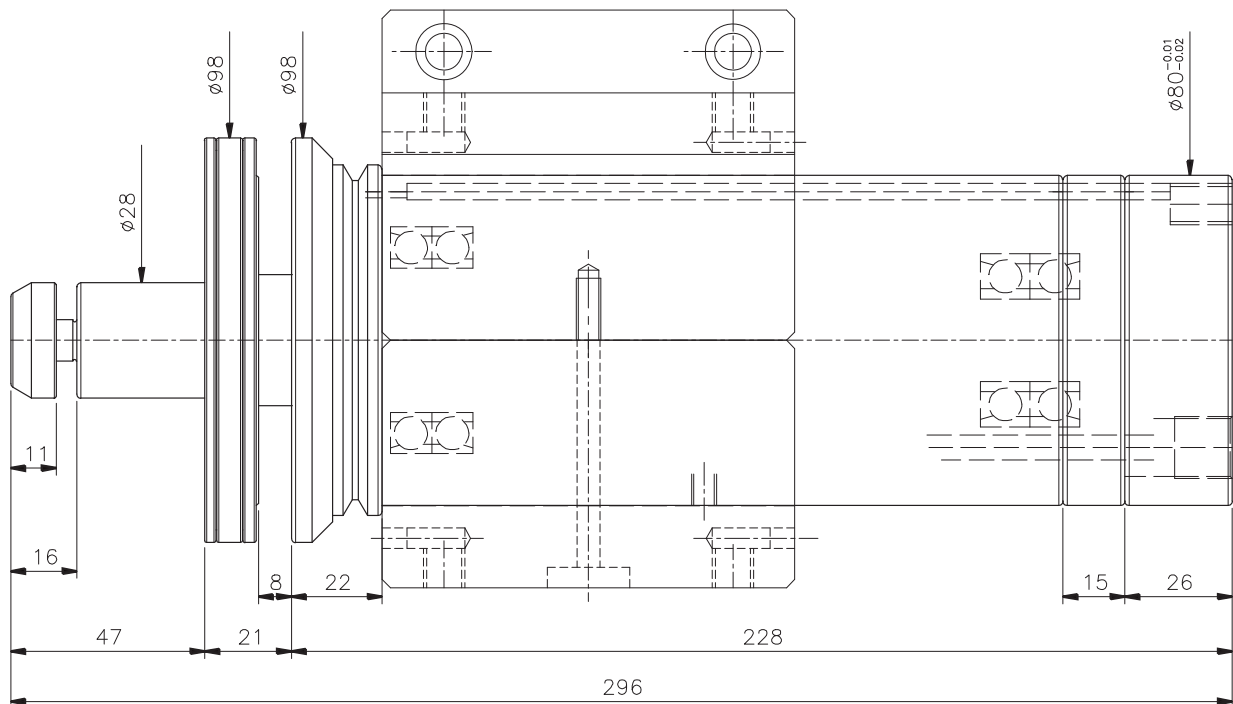
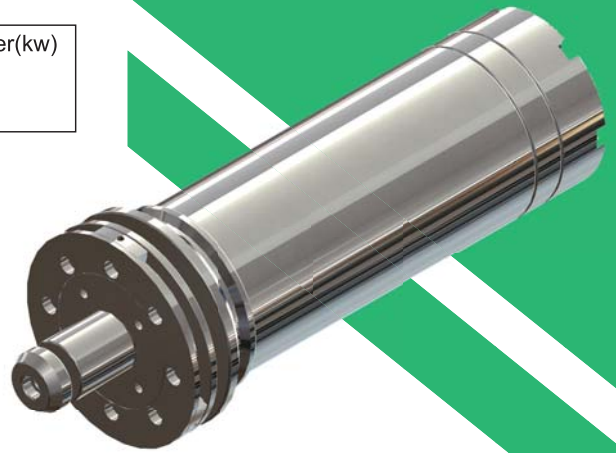
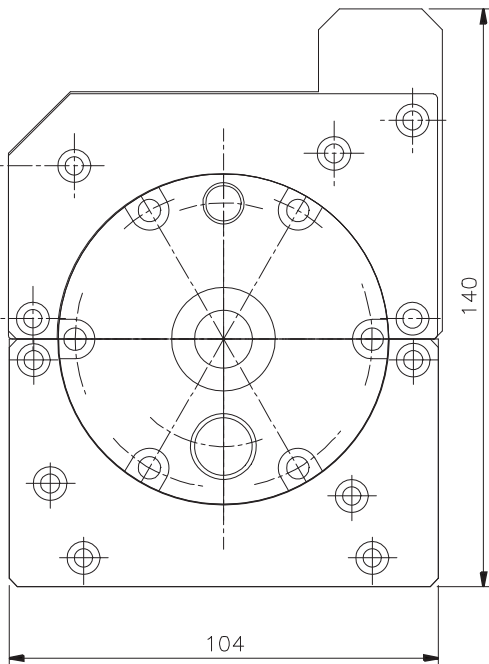
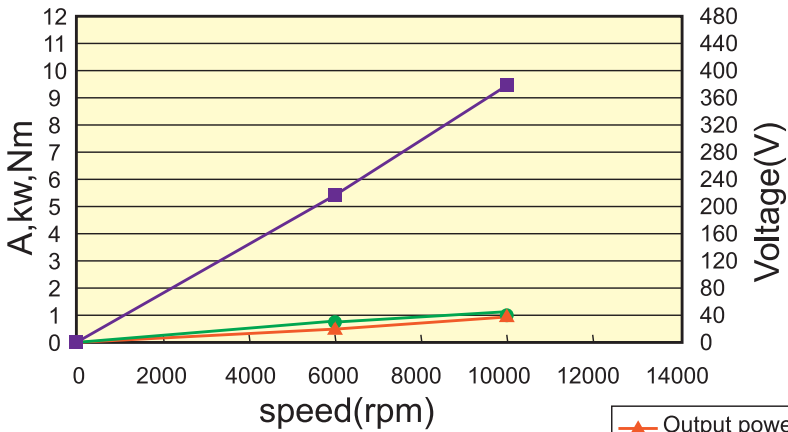

HP0830

Collet	-
Body Outer Dia	Ø120
Max. Speed	30000rpm
Lubrication	Oil-Air
Output Power	13kw
Voltage	350V
Torque	2.4Nm

CNC Grinding Machine Spindles

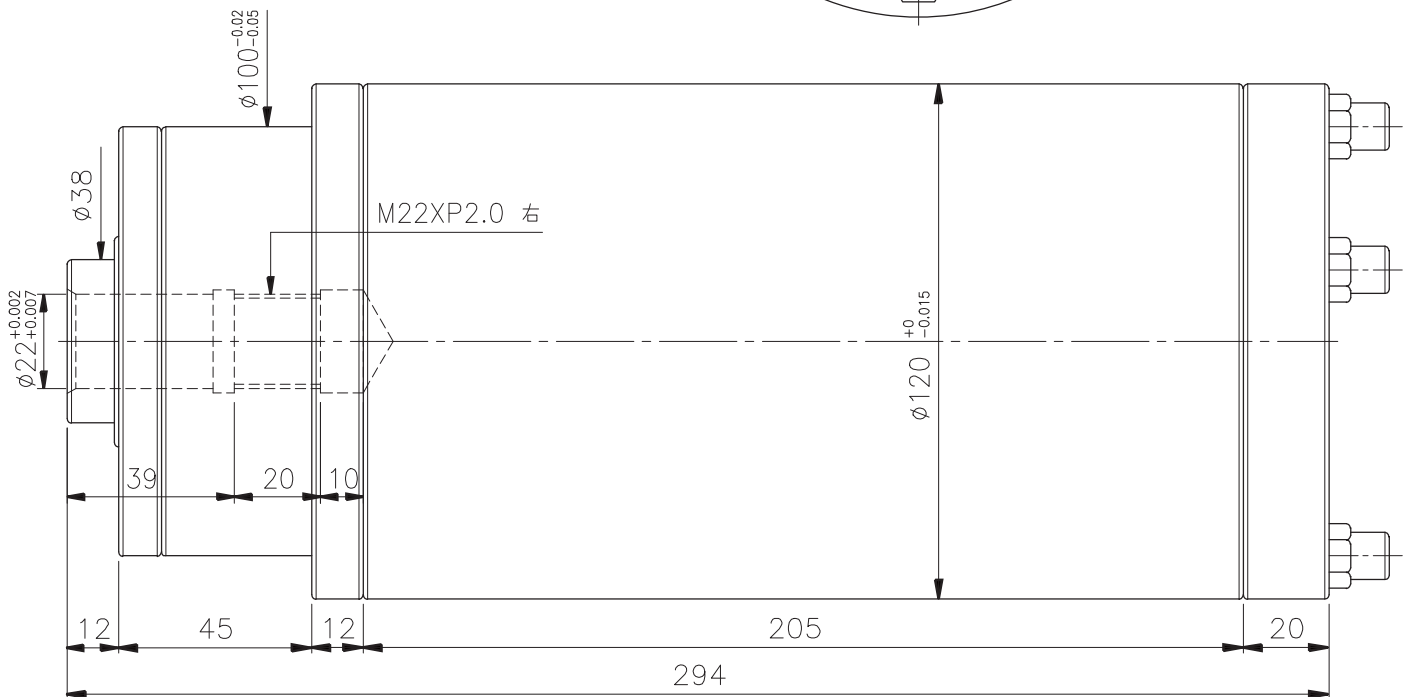
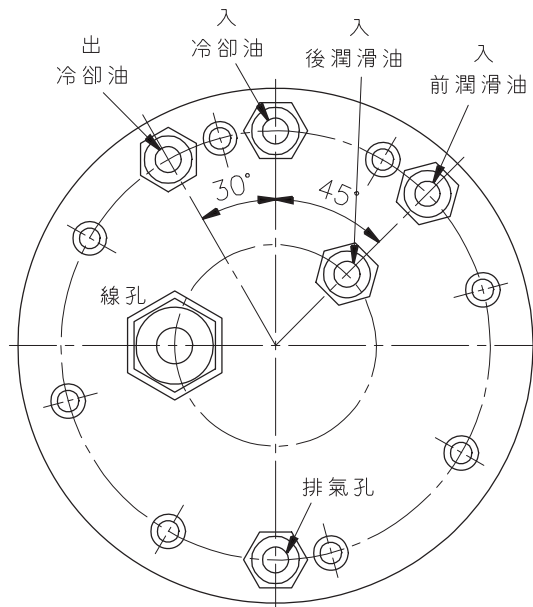
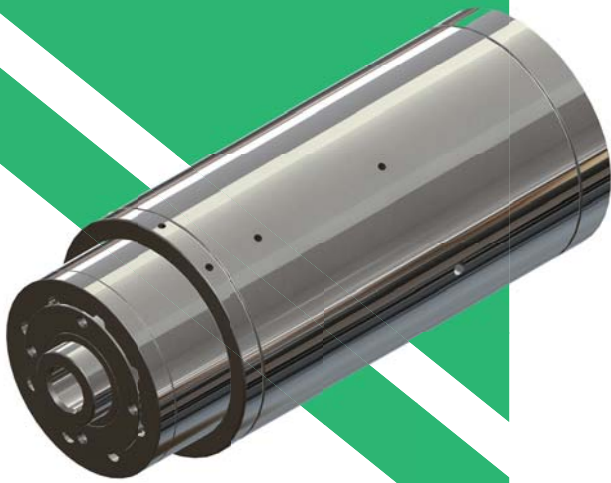
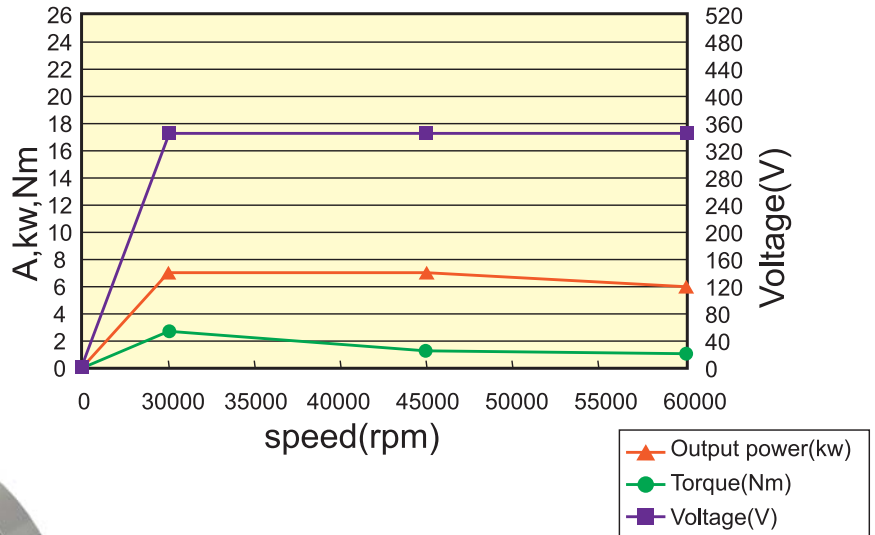

CNC Grinding Machine Spindles

GHB0280

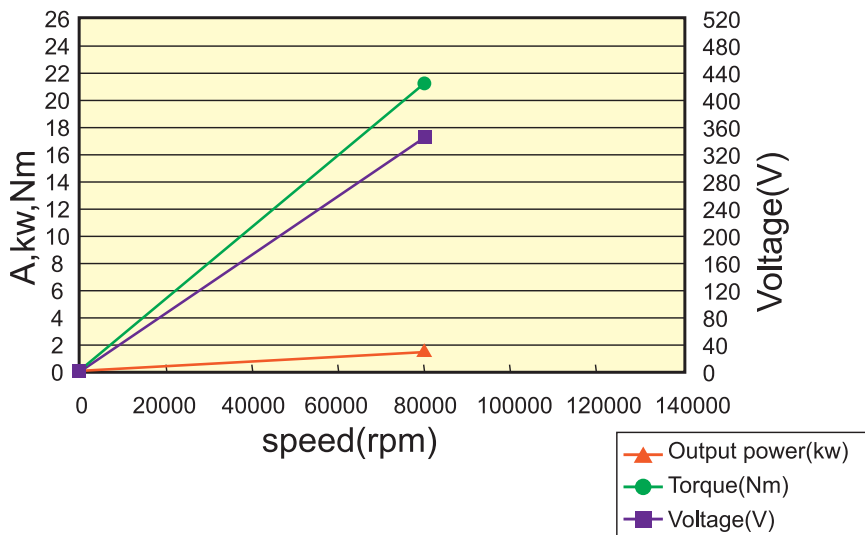

Collet	-
Body Outer Dia	Ø120
Max. Speed	80000rpm
Lubrication	Oil Spot
Output Power	4.7kw
Voltage	220V
Torque	0.2Nm

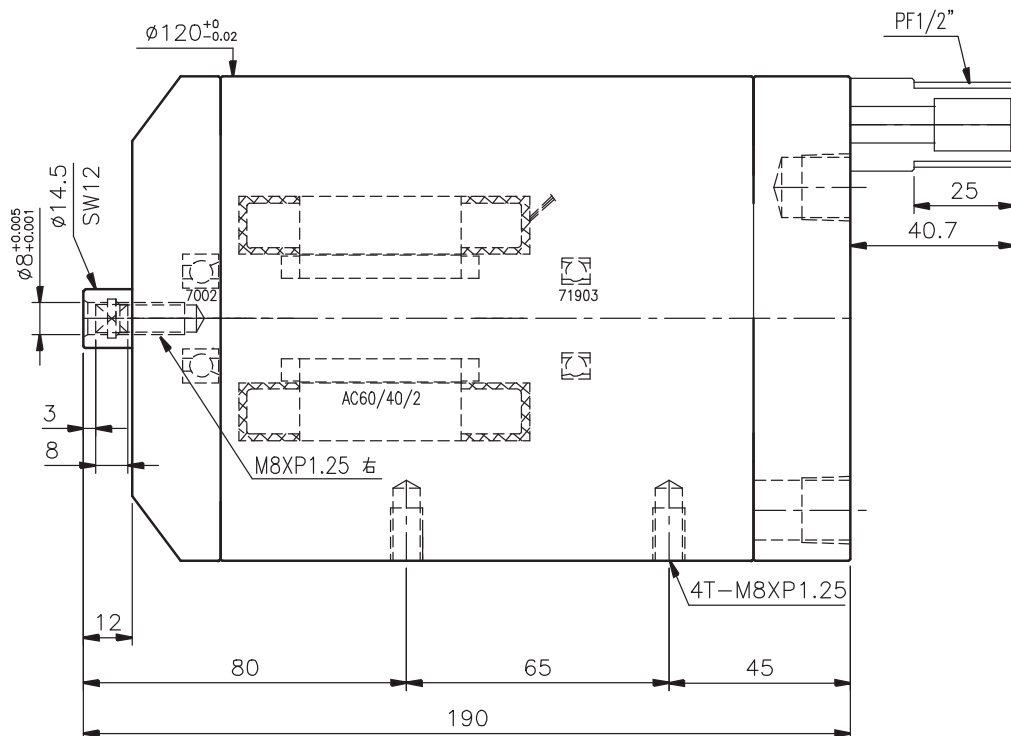
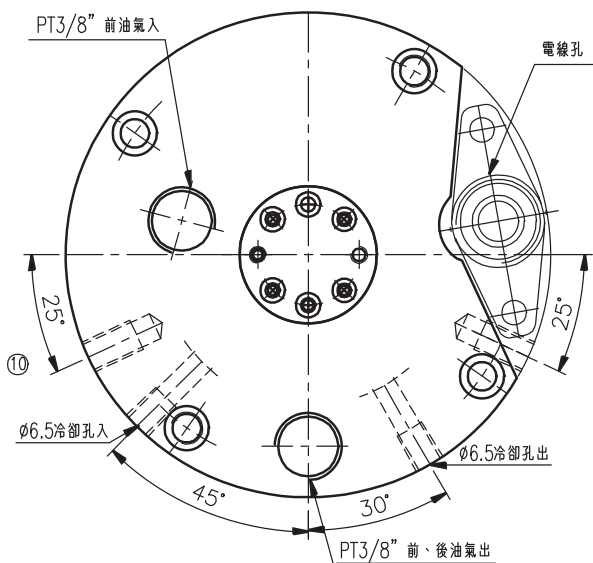
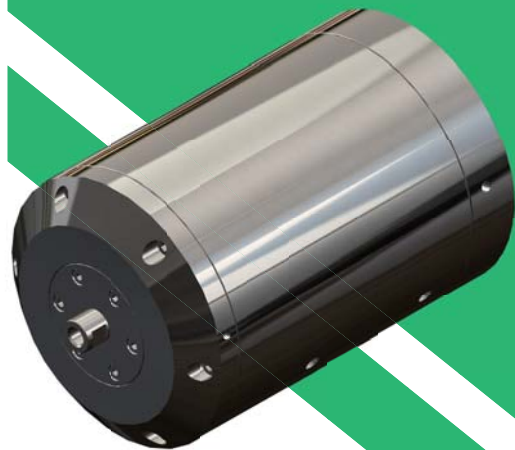

GHB0560

Collet	-
Body Outer Dia	Ø120
Max. Speed	50000rpm
Lubrication	Oil Spot
Output Power	25kw
Voltage	380V
Torque	0.9Nm

CNC Grinding Machine Spindles

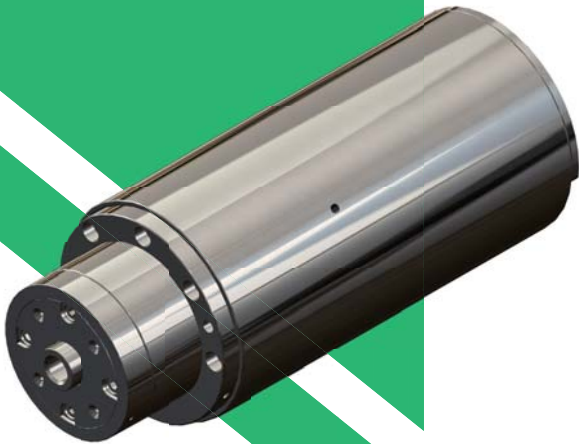
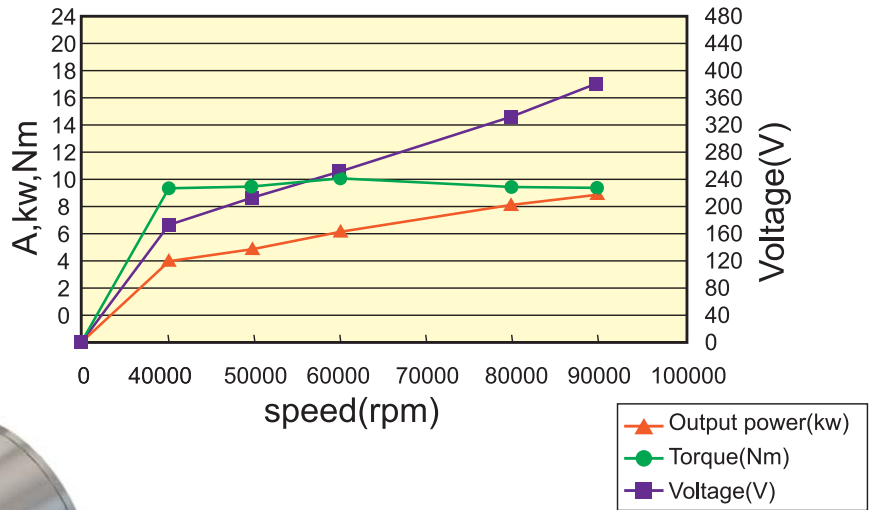

旋轉方向:CCW



P視圖

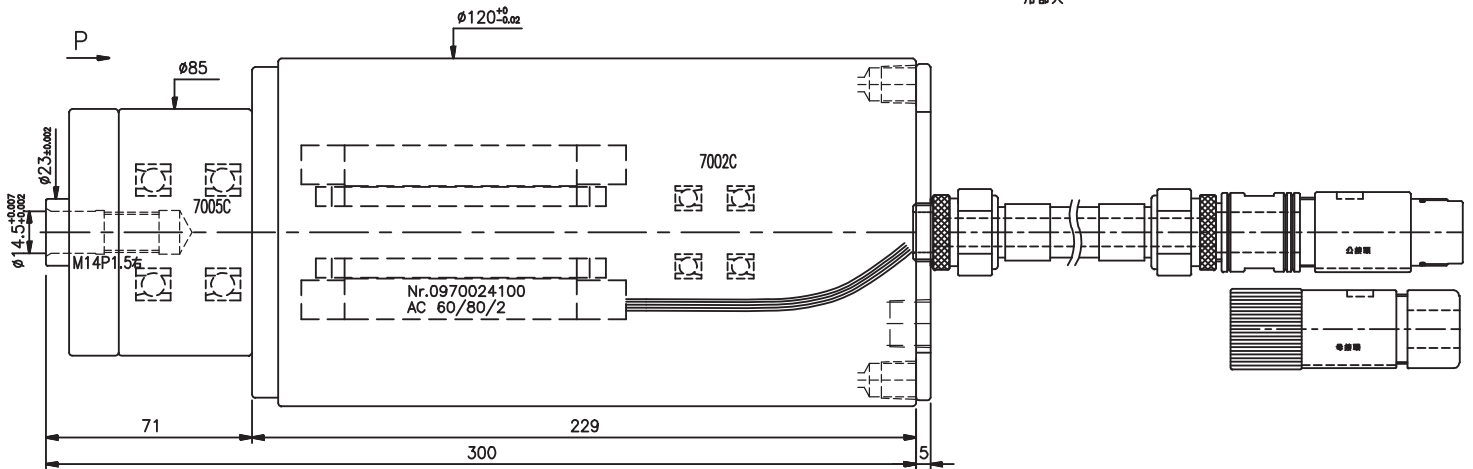
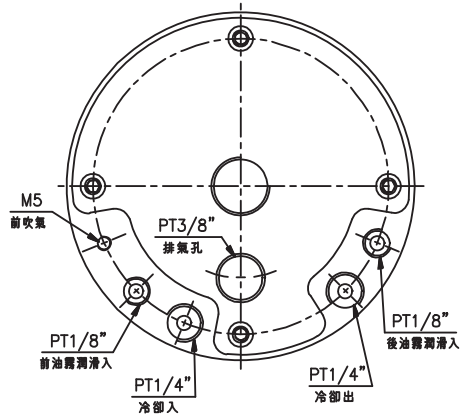

CNC Grinding Machine Spindles

PSB1112

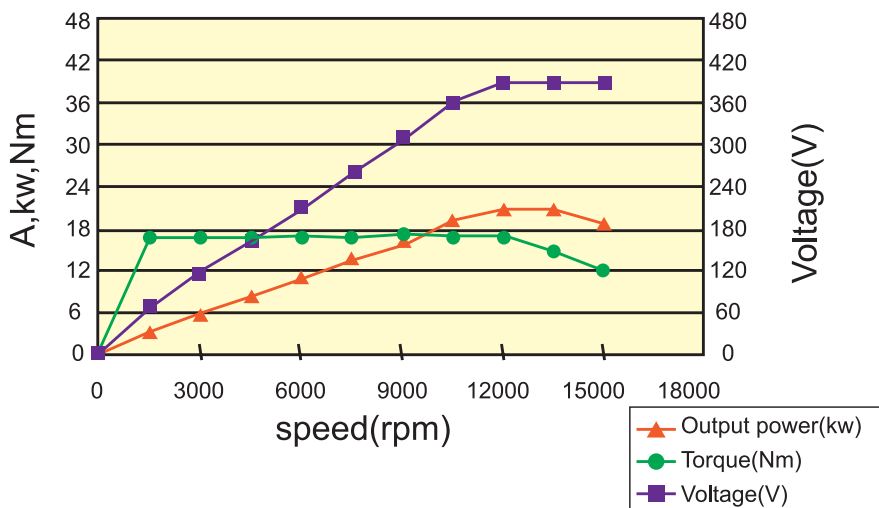

Collet	-
Body Outer Dia	Ø170
Max. Speed	12000rpm
Lubrication	Grease
Output Power	20kw
Voltage	380V
Torque	16Nm

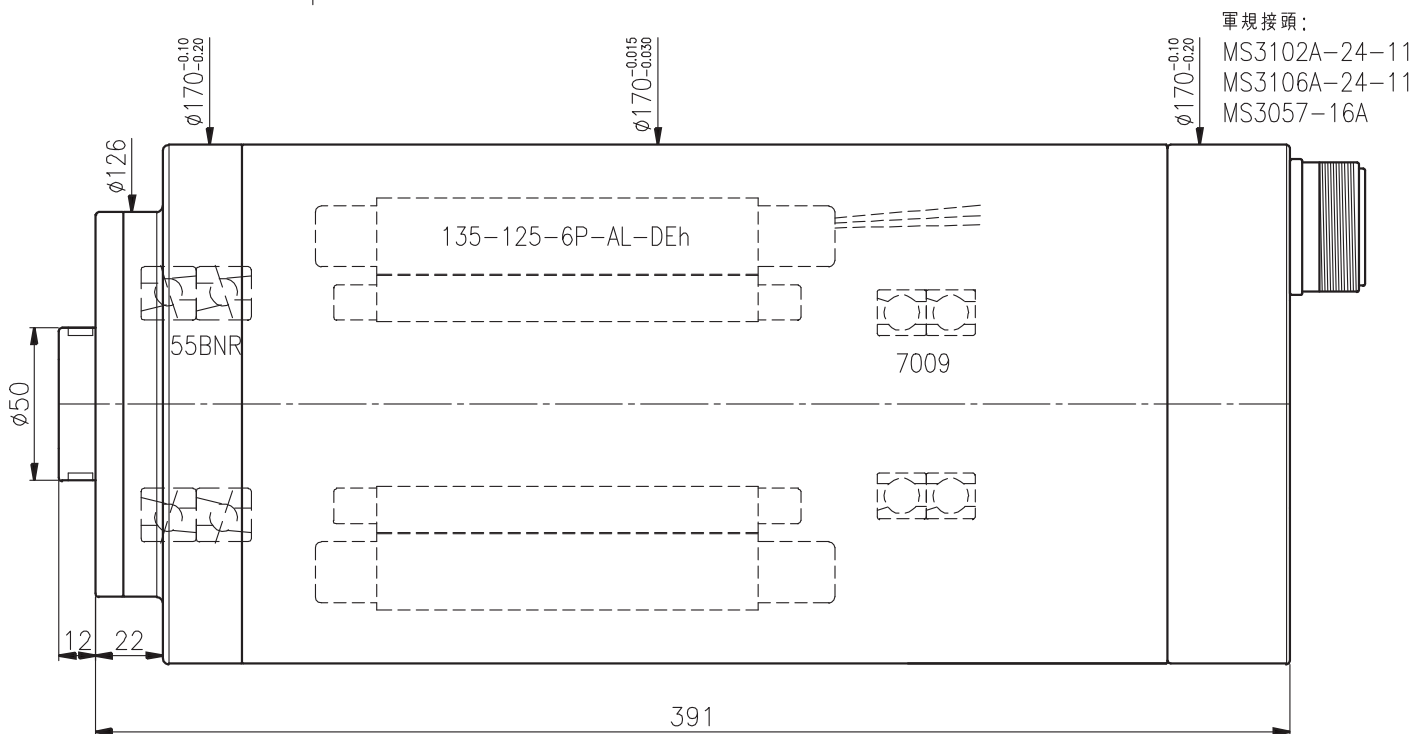
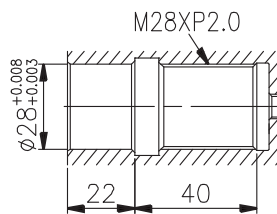
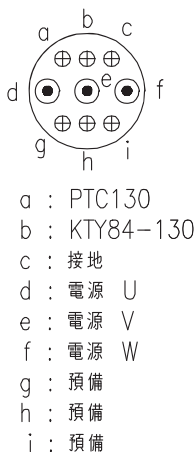
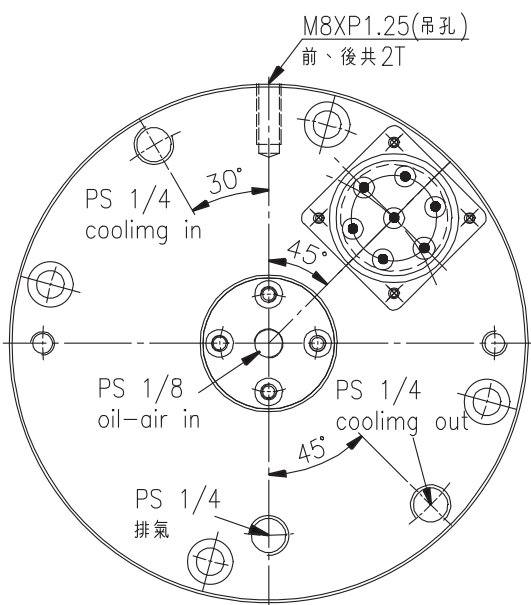

GHB0610

Collet	-
Body Outer Dia	Ø90
Max. Speed	10000rpm
Lubrication	Grease
Output Power	0.9kw
Voltage	220V
Torque	0.4Nm

CNC Grinding Machine Spindles

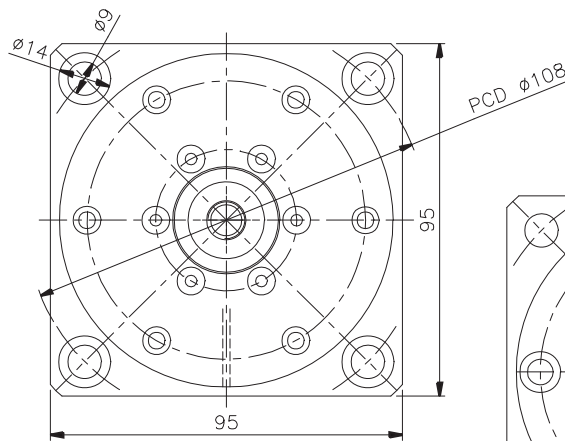
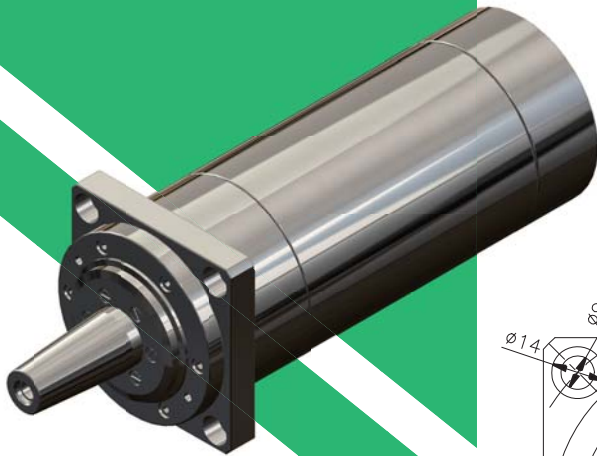
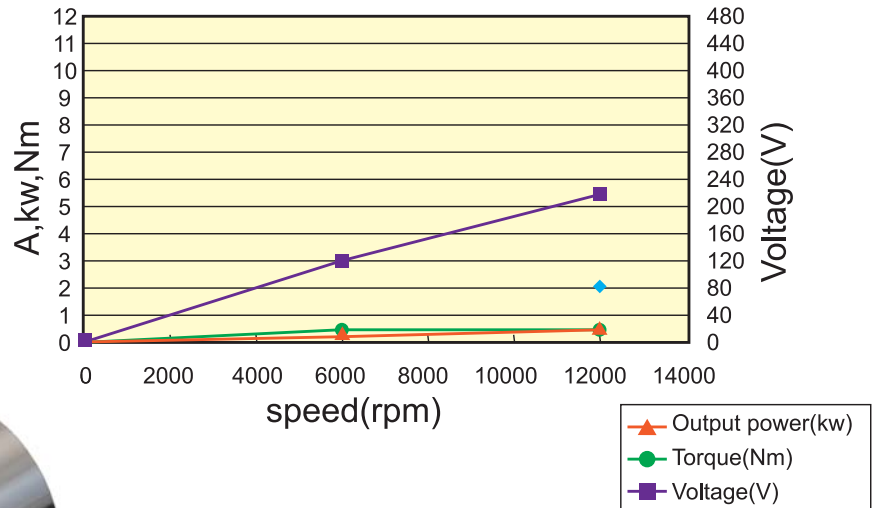

旋轉方向:CCW



P視圖

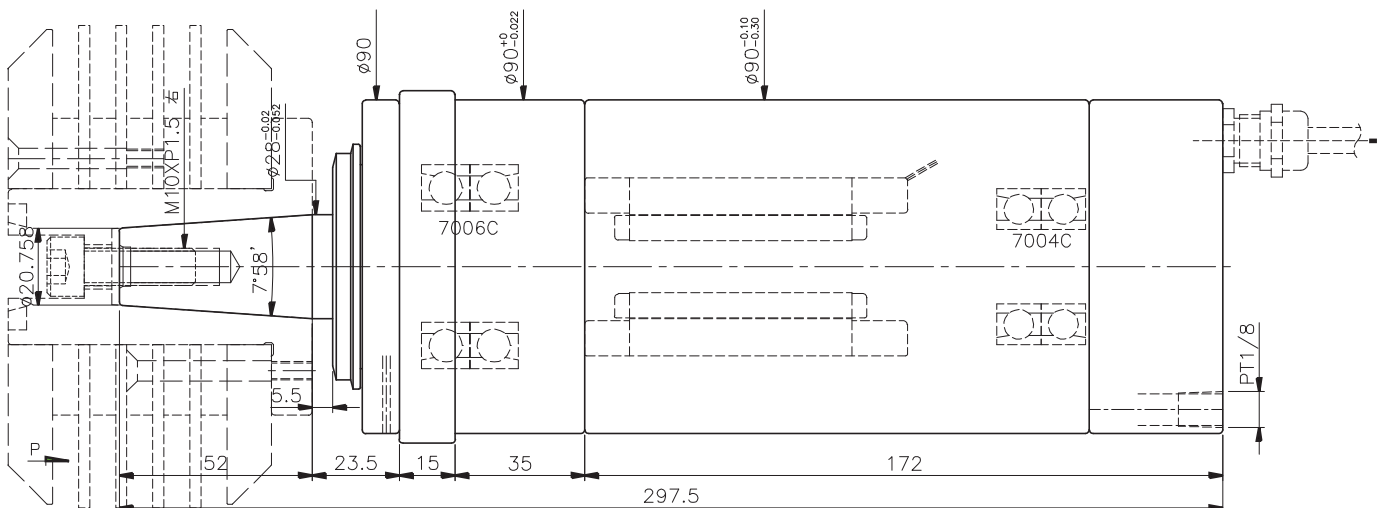
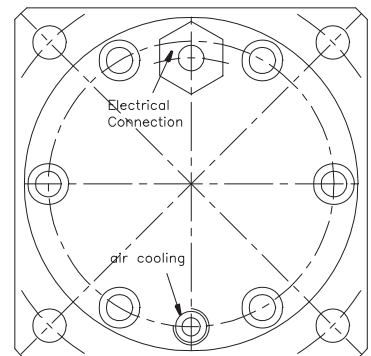

CNC Grinding Machine Spindles

GVB1606

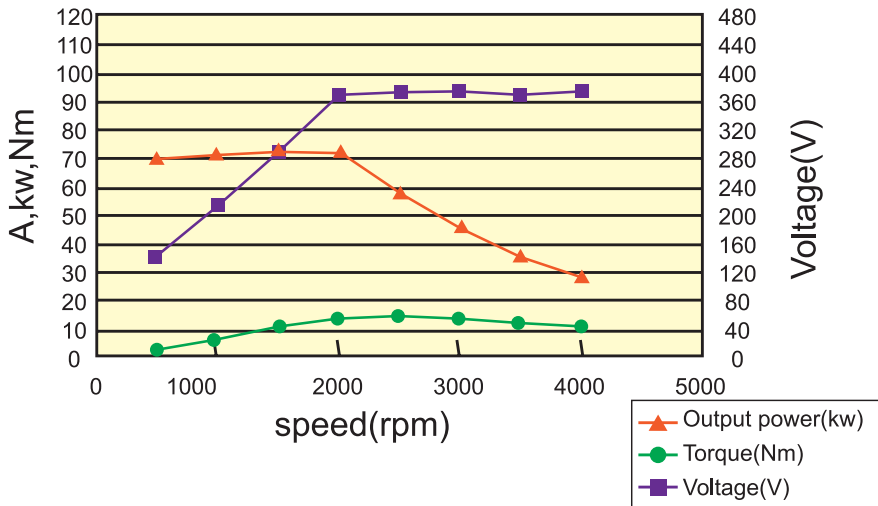

Collet	-
Body Outer Dia	Ø210
Max. Speed	4000rpm
Lubrication	Grease
Output Power	15.1kw
Voltage	370V
Torque	72.1Nm

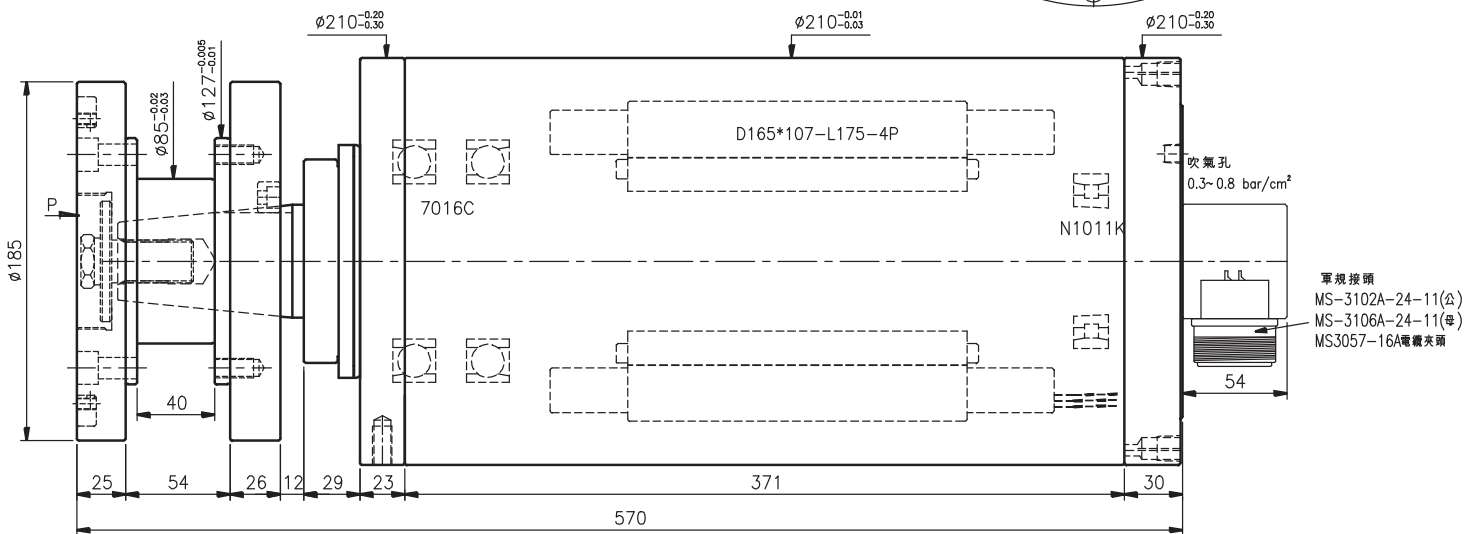
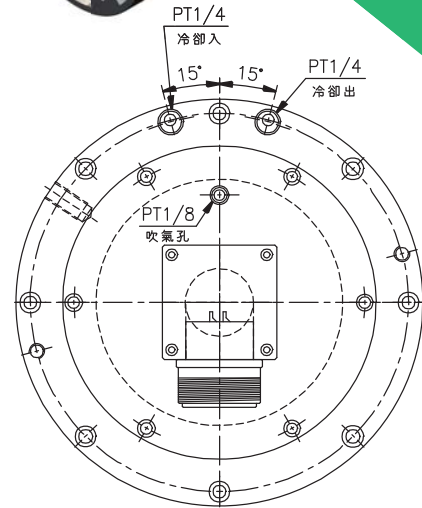
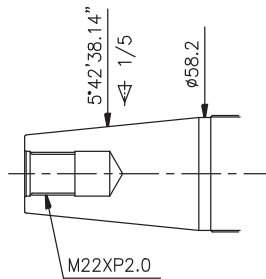
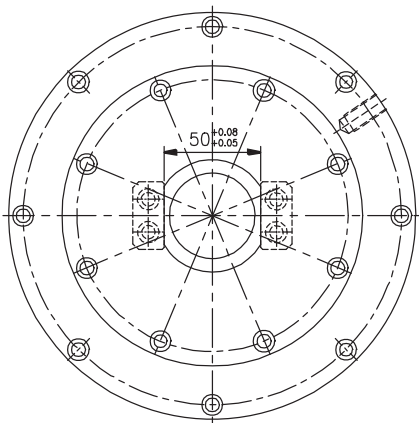
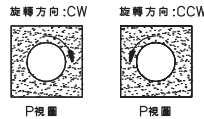
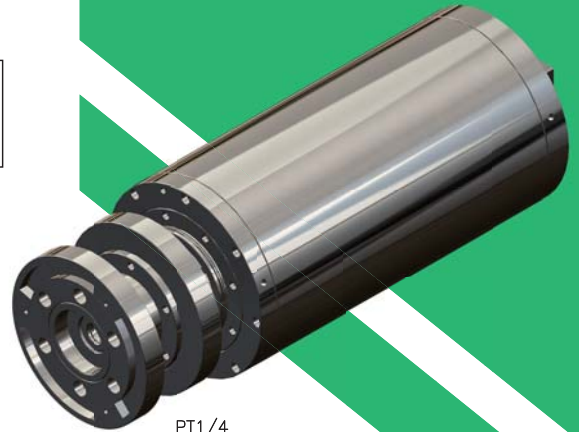

PSB0912

Collet -
 Body Outer Dia $\varnothing 149.5$
 Max. Speed 12000rpm
 Lubrication Grease
 Output Power 8kw
 Voltage 380V
 Torque 6.4Nm

CNC Grinding Machine Spindles

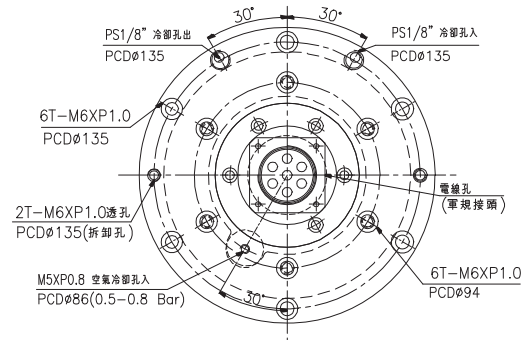
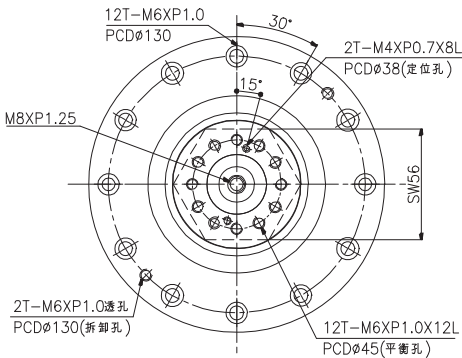
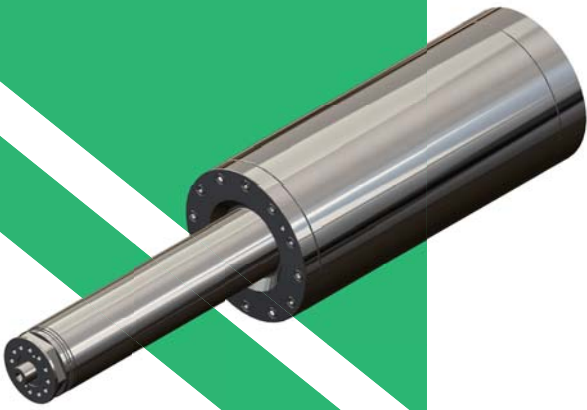
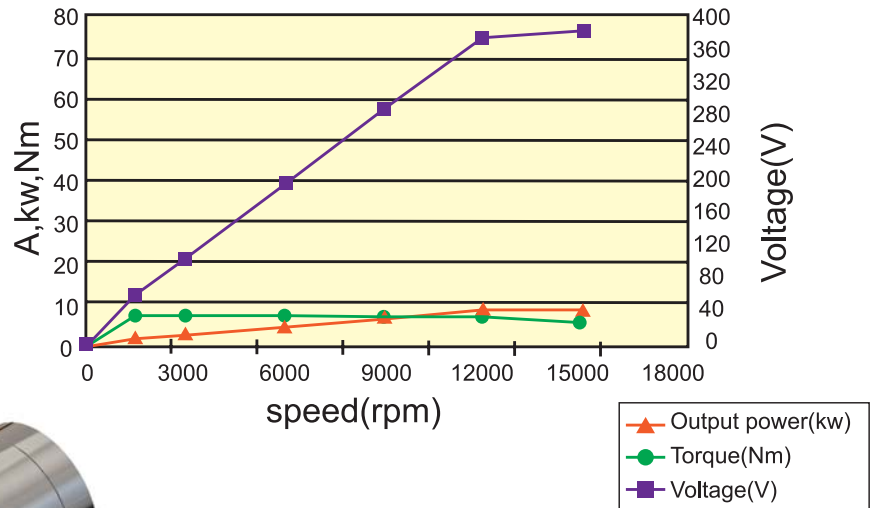

電源: A、B、C
 溫度線: D、E
 接地線: F

